

Customer	Project	Page	2 / 2
Customer no.	Project no. Biral PumpSelector-2026113	Date	22/07/2015
Contact	Position 1 SERIES AXW / AW		
Care of	Location		

AW 16-2 11 6172.0150
 Speed controlled service water pump

Requested data
 Flow 0 m³/h
 Head 0 m
 Fluid Water, pure
 Temperature 20 °C
 Working pressure 10 bar

Operating data
 Flow 0 m³/h
 Head 0 m
 Permitted working pressure 10 bar
 Min. fluid temperature 15 °C
 Max. fluid temperature 85 °C

Required working pressure
 Values are valid for hot water,
 Altitude 500m above sea level.
 Changing of required working pressure at +/- 0.01bar
 per +/- 100m altitude above sea level.

75 °C	90 °C	110 °C
0.1 bar	0.55 bar	1.2 bar

Pump data
 Installation dimension 2" x 180
 Rated voltage 1~230 V 50 Hz
 Rated current 1.25 A
 Leistungsaufnahme P1 0.174 kW
 Insulation class F
 Degree of protection IP44
 Weight 4.2 kg

Short-circuit-proof motor doesn't required overload protection.

Materials

Pump casing	Bronze
Impeller	Plastic
Can	Chrome-Nickel Steel
O- Ringe	EPDM 75
slide bearing	Ceramic
Shaft	Ceramic

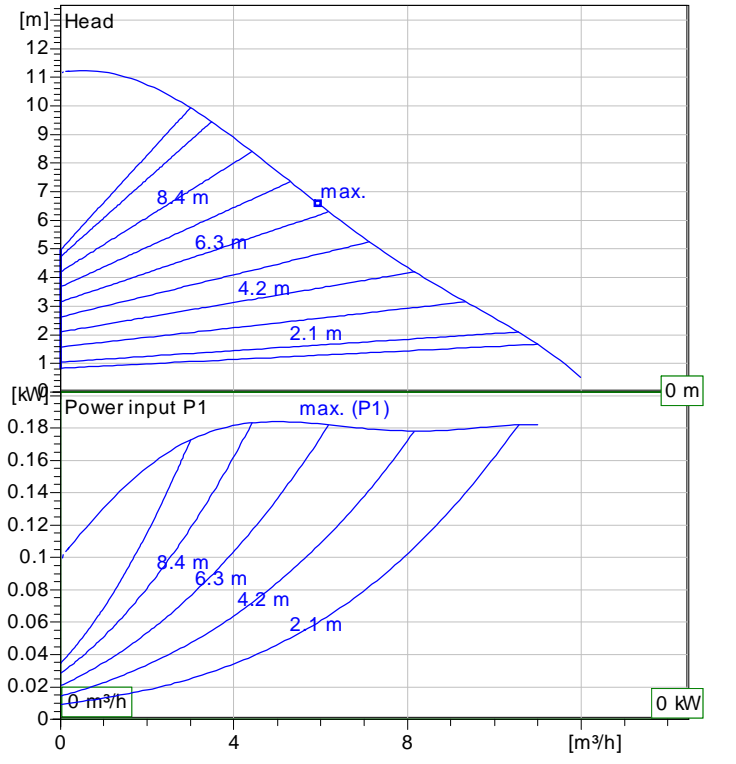
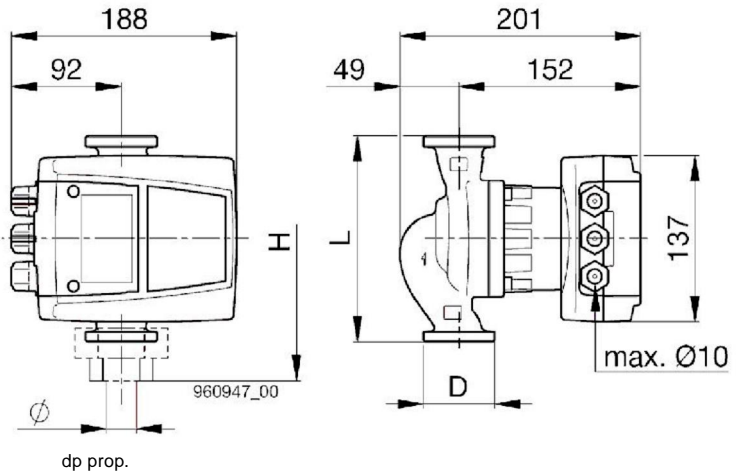

Electrical connection

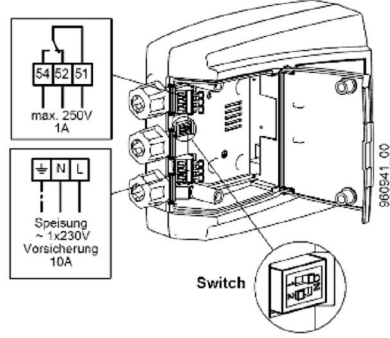

51-54: Error message
 (potential-free closing
 contact closed if there
 is a malfunction)
 contact load max.250V~,1A

51-52:
 (Zero potential normally - closed contact,
 open with fault)
 Contact load max.250V~,1A

Remarks: